



Externe IP Telefoonbel FT23SIP icm HT701



Fasttel België, Klipsenstraat 18A, 9160 Lokeren. Tel +32 (0)9 244 65 20, info@fasttel.be
Fasttel Nederland, Heiligenboom 3, 5066 CB Moergestel. Tel 013 513 65 14, info@fasttel.nl

1. Specificaties

LAN interface	1 xRJ45 10Base-T
Universele voedingsadapter	Input : 100-240VAC Output : +12Vdc, 1000mA
Werkings temperatuur	0 ..40°C
Geluidsniveau buzzer	110dB / 1m

2. Aansluitingen

Verwijder voorzichtig de 4 schroeven van het deksel

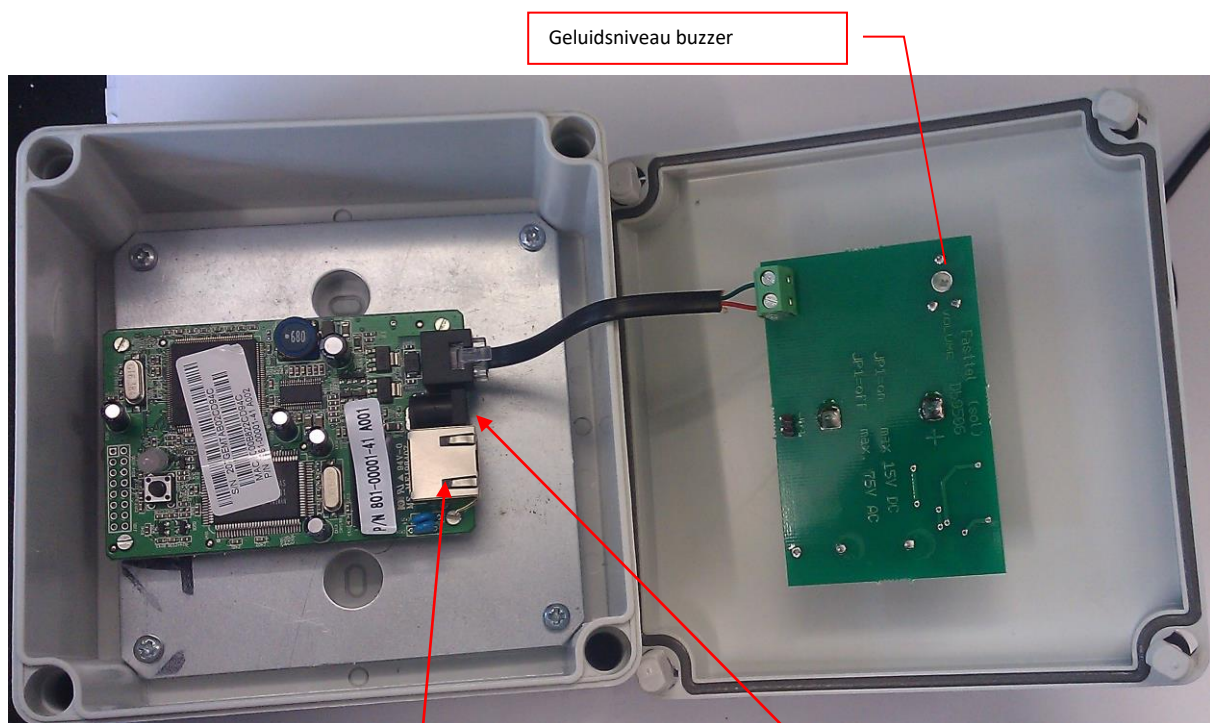

Beneden zit de **RJ45 connector** voor de LAN aansluiting en de **voedingsconnector**

Het snoetje komende van de RJ11 connectie laat U zitten.

Op het deksel bevindt zich een printje met de mogelijkheid om het geluidsniveau van de buzzer in te stellen.

3. Indienstelling.

2.1 Programmatie van de LAN module

- Na aansluiten van FT23SIP dient men eerst te bepalen of hij via DHCP of met een statisch IP adres moet werken
 - Kan op twee manieren
 - Sluit analoog toestel op de RJ11, neem hoorn op en vorm **** kies daarna de optie 01. Met 9 kan men dan wisselen tussen statisch of dynamisch IP-adres.
 - Via optie 02 kan men eventueel het statische IPadres ingeven (9cijfers bv: 192168013004 staat voor 192.168.13.4)
- Nadat het IP adres ingegeven is kan men de IPTALK via de webbrowser benaderen
 - <http://<ipadres IPTALK>> **standaard =DHCP**



Op de volgende bladzijden ,treft U , in rood omkaderd , de belangrijke items die ingesteld moeten zijn.

- Onderstaande instellingen **in rood omkaderd** moeten gemaakt worden in **ADVANCED SETTINGS**

Grandstream Device Configuration

STATUS
BASIC SETTINGS
ADVANCED SETTINGS
FXS PORT

Admin Password: (purposely not displayed for security protection)

Layer 3 QoS: 48 (Diff-Serv or Precedence value)

Layer 2 QoS: 802.1Q/VLAN Tag 0 802.1p priority value 0 (0-7)
802.1p priority value (NATed traffic) 0 (0-7)

STUN server is : (URI or IP:port)

Keep-alive Interval: 20 (in seconds, default 20 seconds)

Use STUN to detect network connectivity: No
 Yes, total STUN response misses 3 to restart DHCP (minimum=3)

Firmware Upgrade and Provisioning: Upgrade Via TFTP HTTP HTTPS
Firmware Server Path:
 Config Server Path:

XML Config File Password:
 HTTP/HTTPS User Name:
 HTTP/HTTPS Password:

Firmware File Prefix: Firmware File Postfix:
 Config File Prefix: Config File Postfix:

Allow DHCP Option 66 to override server:
 No Yes

Automatic Upgrade:
 No Yes, every 10080 minutes(60-5256000).
 Yes, daily at hour 1 (0-23). Yes, weekly on day 1 (0-6).

Always Check for New Firmware at Boot up
 Check New Firmware only when F/W pre/suffix changes
 Always Skip the Firmware Check

Authenticate Conf File: No Yes (cfg file would be authenticated before acceptance if set to Yes)

Firmware Key: (in Hexadecimal Representation)

SSL Certificate:

SSL Private Key:

SSL Private Key Password:
ACS URL:

ACS Username:

ACS Password:

Periodic Inform Enable: No Yes

Periodic Inform Interval:

Connection Request Username:

Connection Request Password:

System Ring Cadence:

Dial Tone:

Ringback Tone:

Busy Tone:

Call Progress Tones: Reorder Tone:

Confirmation Tone:

Call Waiting Tone:

Syntax: f1=val1[,f2=val1[,c=on1/off1[-on2/off2[-on3/off3]]]];

(Frequencies are in Hz and cadence on and off are in ms)

Lock Keypad Update: No Yes (configuration update via keypad is disabled if set to Yes)

Disable Voice Prompt: No Yes (voice prompt is disabled if set to Yes)

Disable Direct IP Call: No Yes (direct IP call is disabled if set to Yes)

NTP Server: (URI or IP address)

Allow DHCP option 42 to override NTP server: No Yes

Syslog Server:

Syslog Level:

Send SIP Log: No Yes

Download Device Configuration:

Upload firmware:

All Rights Reserved Grandstream Networks, Inc. 2006-2011

Klik vervolgens op Update en men bekomt volgend scherm:

Grandstream Device Configuration

STATUS BASIC SETTINGS ADVANCED SETTINGS FXS PORT

Your configuration changes have been saved.
They will take effect on next reboot.

All Rights Reserved Grandstream Networks, Inc. 2006-2011

Kies vervolgens **FXS PORT**

SIP server en Outbound Proxy: Ipadres van de SIP server.
 SIP UserID en Name: intern telefoonnummer van de IPTALK.

Grandstream Device Configuration

STATUS
BASIC SETTINGS
ADVANCED SETTINGS
FXS PORT

Account Active: No Yes

Primary SIP Server: (e.g., sip.mycompany.com, or IP address)

Failover SIP Server: (Optional, used when primary server no response)

Prefer Primary SIP Server: No Yes (yes - will register to Primary Server if Failover registration expires)

Outbound Proxy: (e.g., proxy.myprovider.com, or IP address, if any)

SIP Transport: UDP TCP TLS (default is UDP)

NAT Traversal (STUN): No No, but send keep-alive Yes

SIP User ID: (the user part of an SIP address)

Authenticate ID: (can be identical to or different from SIP User ID)

Authenticate Password: (purposely not displayed for security protection)

Name: (optional, e.g., John Doe)

DNS Mode: A Record SRV NAPTR/SRV

Tel URI:

SIP Registration: No Yes

Unregister On Reboot: No Yes

Outgoing Call without Registration: No Yes

Register Expiration: (in minutes. default 1 hour, max 45 days)

SIP Registration Failure Retry Wait Time: (in seconds. Between 1-3600, default is 20)

Local SIP port: (default is 5060 for UDP and TCP; 5061 for TLS)

Local RTP port: (1024-65535, default 5004)

Use Random Port: No Yes

Refer-To Use Target Contact: No Yes

Transfer on Conference Hangup: No Yes

Enable Ring-Transfer: No (RFC5589 Semi-Attended Transfer) Yes

Disable Bellcore Style 3-Way Conference: No Yes (Using star code *23 for 3-way conference)

Remove OBP from Route Header: No Yes

Support SIP Instance ID: No Yes

Validate Incoming SIP Message: No Yes

Check SIP User ID for incoming INVITE: No Yes (no direct IP calling if Yes)

Allow Incoming SIP Messages from SIP Proxy Only: No Yes (no direct IP calling if Yes)

SIP T1 Timeout:

SIP T2 Interval:

DTMF Payload Type:

Preferred DTMF method: (in listed order)
 Priority 1:
 Priority 2:
 Priority 3:

Disable DTMF Negotiation: No (negotiate with peer) Yes (use above DTMF order without negotiation)

Send Hook Flash Event: No Yes (Hook Flash will be sent as a DTMF event if set to Yes)

Enable Call Features: No Yes (if Yes, call features using star codes will be supported locally)

Offhook Auto-Dial: (User ID/extension to dial automatically when offhook)

Proxy-Require:

Use NAT IP: (used in SIP/SDP message if specified)

Distinctive Ring Tone:
Ring Tone 1 used if incoming caller ID is
Ring Tone 1 used if incoming caller ID is
Ring Tone 1 used if incoming caller ID is

Disable Call-Waiting: No Yes

Disable Call-Waiting Caller ID: No Yes

Disable Call-Waiting Tone: No Yes

Disable Receiver Offhook Tone: No Yes (ROH tone will not be played after offhook for 60 seconds)

Disable Reminder Ring for On-Hold Call: No Yes

Disable Visual MWI: No Yes

Ring Timeout: (10-300, default is 60 seconds)

Delayed Call Forward Wait Time: (Allowed range 1-120, in seconds.)

No Key Entry Timeout: (in seconds, default is 4 seconds)

Early Dial: No Yes (use "Yes" only if proxy supports 484 response)

Dial Plan Prefix: (this prefix string is added to each dialed number)

Use # as Dial Key: No Yes (if set to Yes, "#" will function as the "(Re-)Dial" key)

Dial Plan: }

SUBSCRIBE for MWI: No, do not send SUBSCRIBE for Message Waiting Indication
 Yes, send periodical SUBSCRIBE for Message Waiting Indication

Send Anonymous: No Yes (caller ID will be blocked if set to Yes)

Anonymous Call Rejection: No Yes

Special Feature:

Session Expiration: (in seconds, default 180 seconds)

Min-SE: (in seconds, default and minimum 90 seconds)

Caller Request Timer: No Yes (Request for timer when making outbound calls)

Callee Request Timer: No Yes (When caller supports timer but did not request one)

Force Timer: No Yes (Use timer even when remote party does not support)

UAC Specify Refresher: UAC UAS Omit (Recommended)

UAS Specify Refresher: UAC UAS (When UAC did not specify refresher tag)

Force INVITE: No Yes (Always refresh with INVITE instead of UPDATE)

Send Re-INVITE After Fax: No Yes

Enable 100rel: No Yes

Use First Matching Vocoder in 200OK SDP: No Yes

Preferred Vocoder: (in listed order)
choice 1:
choice 2:
choice 3:
choice 4:

G723 Rate: 6.3kbps encoding rate 5.3kbps encoding rate
iLBC Frame Size: 20ms 30ms
iLBC Payload Type: (between 96 and 127, default is 97)
VAD: No Yes
Symmetric RTP: No Yes
Fax Mode: T.38 Pass-Through
Re-INVITE After Fax Tone Detected: Enabled Disabled
Jitter Buffer Type: Fixed Adaptive
Jitter Buffer Length: Low Medium High
SRTP Mode: Disabled Enabled but not forced Enabled and forced

SLIC Setting: EUROPEAN CTR21
Caller ID Scheme: ETSI-FSK during ringing
Polarity Reversal: No Yes (~~reverse polarity upon call establishment and termination~~)
Loop Current Disconnect: No Yes (loop current disconnect upon call termination)
Loop Current Disconnect Duration: (100 - 10000 milliseconds. Default 200 milliseconds)
Hook Flash Timing: In 40-2000 milliseconds range, minimum: maximum:
On Hook Timing: (In 40-2000 milliseconds range, default is 400)
Gain: TX RX
Disable Line Echo Canceller (LEC): No Yes

Ring Tones (Syntax: c=on1/off1-on2/off2-on3/off3;)
Ring Tone 1:
Ring Tone 2:
Ring Tone 3:
Ring Tone 4:
Ring Tone 5:
Ring Tone 6:
Ring Tone 7:
Ring Tone 8:
Ring Tone 9:
Ring Tone 10:

All Rights Reserved Grandstream Networks, Inc. 2006-2011

Klik vervolgens op **Update** en men bekomt volgend scherm.

Grandstream Device Configuration

[STATUS](#) [BASIC SETTINGS](#) [ADVANCED SETTINGS](#) [FXS PORT](#)

Your configuration changes have been saved.
They will take effect on next reboot.

All Rights Reserved Grandstream Networks, Inc. 2006-2011

Klik vervolgens op **BASIC SETTINGS** en men bekomt volgend scherm.

Grandstream Device Configuration

STATUS
BASIC SETTINGS
ADVANCED SETTINGS
FXS PORT

End User Password: (purposely not displayed for security protection)

Web Port: (default for HTTP is 80)

Telnet Server: No Yes

IP Address: dynamically assigned via DHCP

DHCP hostname: (optional)

DHCP domain: (optional)

DHCP vendor class ID: (optional)

use PPPoE

PPPoE account ID:

PPPoE password:

PPPoE Service Name:

Preferred DNS server:

statically configured as:

IP Address:

Subnet Mask:

Default Router:

DNS Server 1:

DNS Server 2:

Time Zone: GMT+1:00 (Paris, Amsterdam, Berlin, Rome, Vienna, Madrid, Warsaw, Brussels) ▼

Self-Defined Time Zone: (For example: MTZ+6MDT+5,M4.1.0,M11.1.0)

Allow DHCP server to set Time Zone: No Yes

Language: ▼

Reset Type: ▼

All Rights Reserved Grandstream Networks, Inc. 2006-2011

Hier kan eventueel nog de instellingen gemaakt worden indien een statisch IPadres gewent is.

Kies vervolgens op **Reboot**.

-